

STANDARD  
CONSTRUCTION  
DETAILS

TRAFFIC

AUGUST 2010

*Addison!*<sup>®</sup>

PUBLIC WORKS DEPARTMENT

# TABLE OF CONTENTS

## TRAFFIC

---

SIGN POST IN TURF DETAIL	SD-T01
SIGN POST IN SIDEWALK DETAIL	SD-T02
STREET NAME SIGN SPECIFICATIONS	SD-T03
TYPICAL PAVEMENT MARKING LAYOUT	SD-T04
TYPICAL PAVEMENT MARKING DETAILS	SD-T05
RAILROAD CROSSING MARKINGS	SD-T06

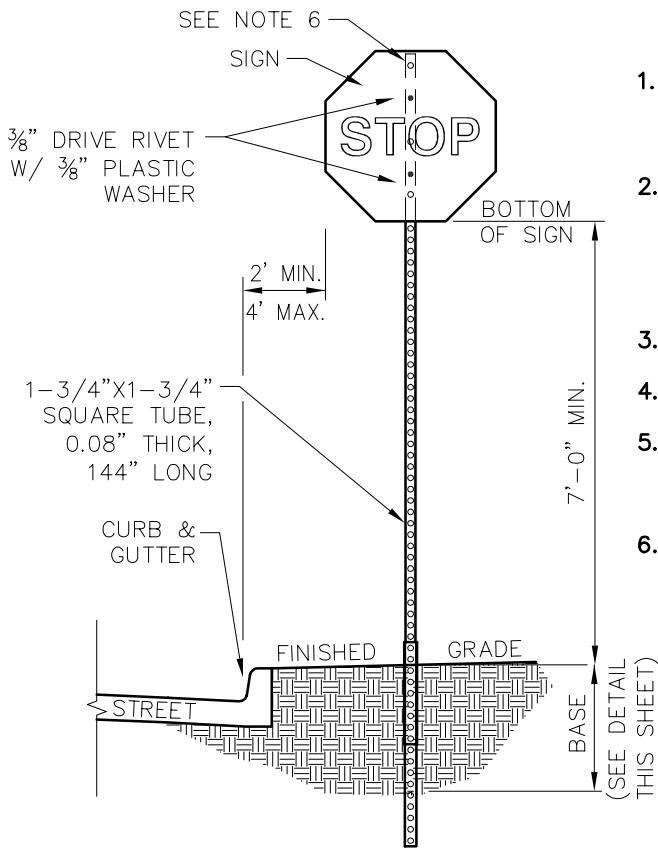

**TYPICAL POST DETAIL**

NTS

**TRAFFIC CONTROL NOTES:**

1. ALL SIGNAGE, BARRICADES, AND PAVEMENT MARKINGS SHALL BE IN ACCORDANCE WITH THE LATEST REVISIONS OF THE TEXAS MANUAL ON UNIFORM TRAFFIC CONTROL DEVICES (2006) AND THE STANDARD HIGHWAY SIGN DESIGNS FOR TEXAS (2010).
2. LOCATIONS SHOWN FOR SIGNAGE AND PAVEMENT MARKINGS ARE APPROXIMATE; FINAL LOCATIONS MAY CHANGE DUE TO POST CONSTRUCTION CONDITIONS AND PRESENCE OF OTHER PHYSICAL FEATURES. FINAL LOCATION OF ALL TRAFFIC CONTROL DEVICES SHALL BE FIELD VERIFIED WITH THE PUBLIC WORKS DEPARTMENT PRIOR TO INSTALLATION.
3. ALL SIGNS SHALL BE HIGH INTENSITY AND THE SIZES SHALL BE STANDARD UNLESS OTHERWISE NOTED.
4. ALL SIGNS, POSTS, AND MATERIALS SHALL BE INSTALLED PER DETAILS IN THIS MANUAL.
5. FOR STOP SIGNS THAT WILL ACCEPT FUTURE STREET SIGNS, EXTEND POST ABOVE THE STOP SIGN SO THAT 2 HOLES ARE AVAILABLE FOR MOUNTING. FOR ALL OTHERS, POST SHALL NOT EXTEND ABOVE THE SIGN.
6. CHANGES TO TYPICAL SIGN POST LOCATION MADE AT ENGINEER'S DISCRETION.

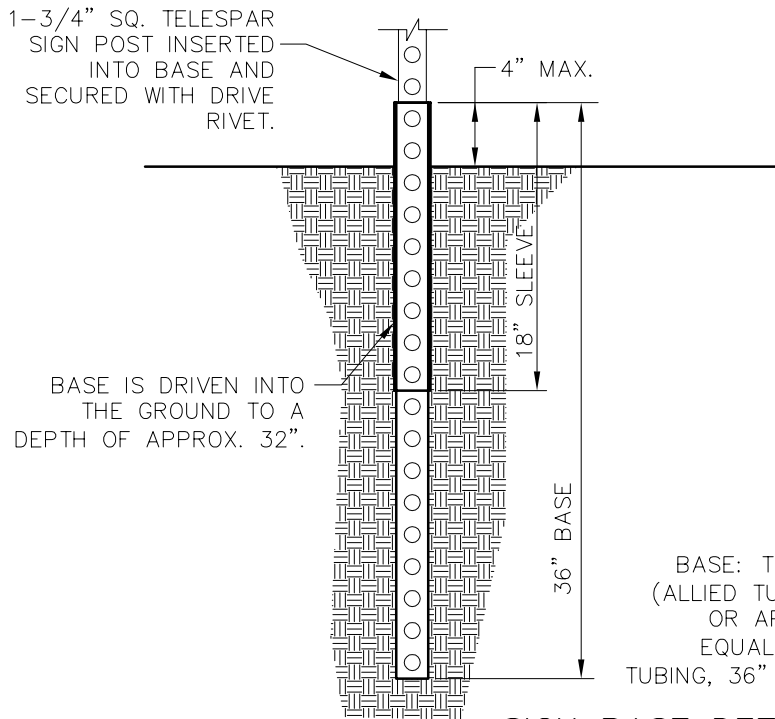

BASE: TELESPAR  
(ALLIED TUBE, INC.  
OR APPROVED  
EQUAL) 2" SQ.  
TUBING, 36" LENGTH.

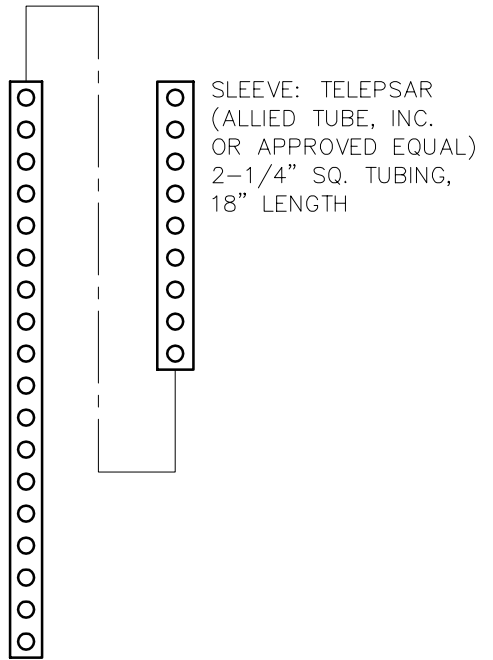

**SIGN BASE DETAIL IN TURF**

**Addison!**

PUBLIC WORKS DEPARTMENT

**SIGN POST IN TURF DETAIL**

**STANDARD CONSTRUCTION DETAILS TRAFFIC**

DATE:  
AUGUST, 2010

REV DATE:  
-

SHEET :  
SD-T01

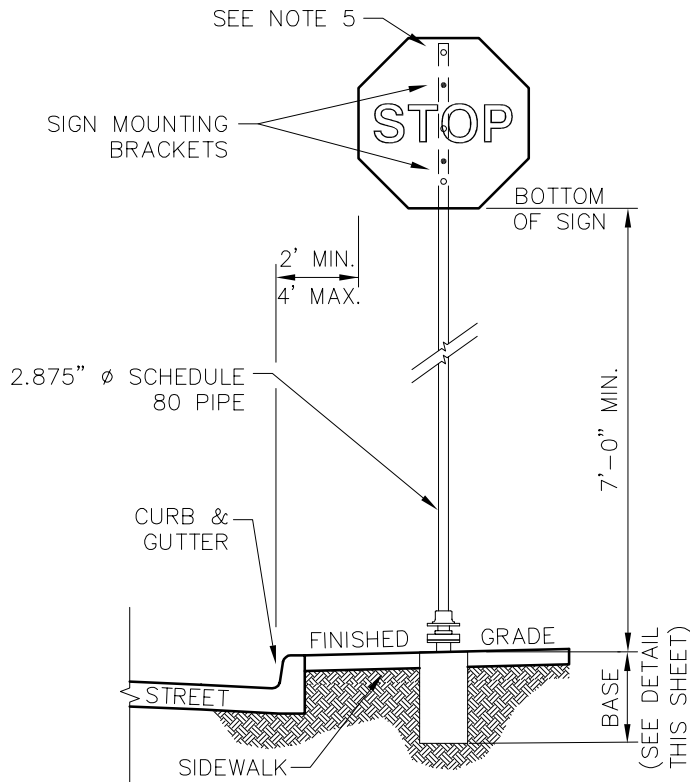

**TYPICAL POST  
DETAIL**

NTS

**TRAFFIC CONTROL NOTES:**

1. ALL SIGNAGE, BARRICADES, AND PAVEMENT MARKINGS SHALL BE IN ACCORDANCE WITH THE LATEST REVISIONS OF THE TEXAS MANUAL ON UNIFORM TRAFFIC CONTROL DEVICES (2006) AND THE STANDARD HIGHWAY SIGN DESIGNS FOR TEXAS (2010).
2. LOCATIONS SHOWN FOR SIGNAGE AND PAVEMENT MARKINGS ARE APPROXIMATE; FINAL LOCATIONS MAY CHANGE DUE TO POST CONSTRUCTION CONDITIONS AND PRESENCE OF OTHER PHYSICAL FEATURES. FINAL LOCATION OF ALL TRAFFIC CONTROL DEVICES SHALL BE FIELD VERIFIED WITH THE PUBLIC WORKS DEPARTMENT PRIOR TO INSTALLATION.
3. ALL SIGNS SHALL BE HIGH INTENSITY AND THE SIZES SHALL BE STANDARD UNLESS OTHERWISE NOTED.
4. ALL SIGNS, POSTS, AND MATERIALS SHALL BE INSTALLED PER DETAILS IN THIS MANUAL.
5. FOR STOP SIGNS THAT WILL ACCEPT FUTURE STREET SIGNS, EXTEND POST ABOVE THE STOP SIGN SO THAT 2 HOLES ARE AVAILABLE FOR MOUNTING. FOR ALL OTHERS, POST SHALL NOT EXTEND ABOVE THE SIGN.
6. CHANGES TO TYPICAL SIGN POST LOCATION MADE AT ENGINEER'S DISCRETION.

**SPECIFICATIONS FOR SCHEDULE 80 PIPE (2.875" OUTSIDE DIAMETER)**

- 0.267" NOMINAL WALL THICKNESS
- STEEL TUBING PER ASTM A500 Gr C
- OTHER SEAMLESS OR ELECTRIC-RESISTANCE WELDED STEEL TUBING OR PIPE WITH EQUIVALENT
- OUTSIDE DIAMETER AND WALL THICKNESS MAY BE USED IF THEY MEET THE FOLLOWING:
  - 46,000 PSI MINIMUM YIELD STRENGTH
  - 62,000 PSI MINIMUM TENSILE STRENGTH
  - 21% MINIMUM ELONGATION IN 2"
- WALL THICKNESS (UNCOATED) SHALL BE WITHIN THE RANGE OF 0.248" TO 0.304"
- OUTSIDE DIAMETER (UNCOATED) SHALL BE WITHIN THE RANGE OF 2.855" TO 2.895"
- POWDER COATED FINISH, COLOR TO BE SELECTED BY THE TOWN OF ADDISON

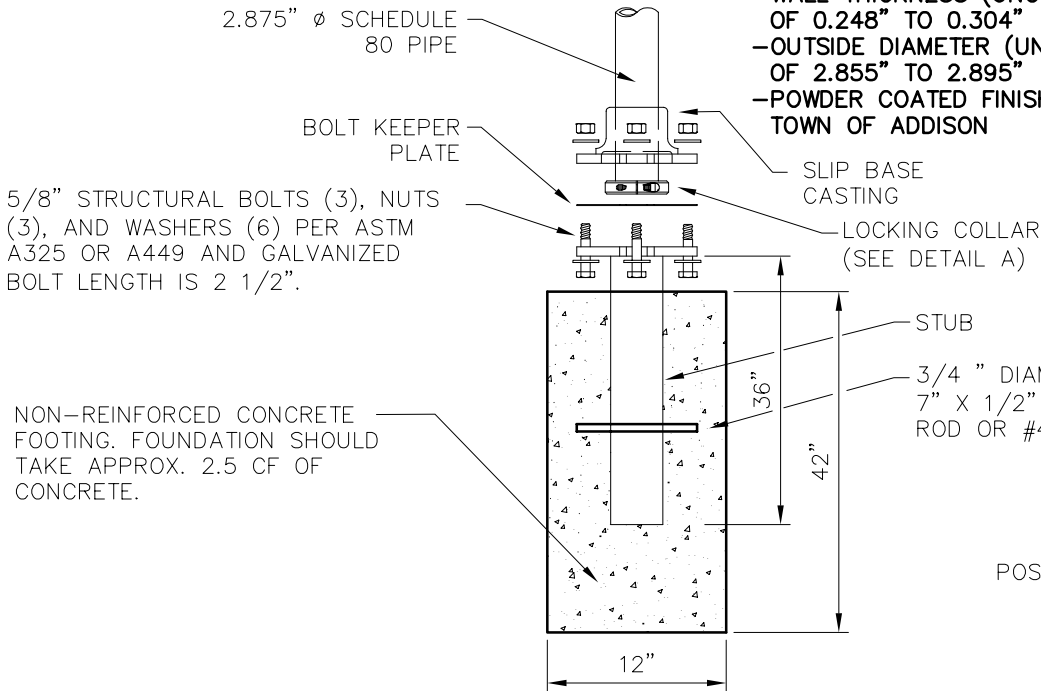

**SIGN BASE DETAIL**

NTS

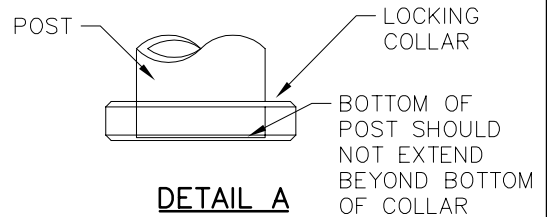

**DETAIL A**

NTS

**Addison!**

PUBLIC WORKS DEPARTMENT

**SIGN POST IN  
SIDEWALK DETAIL**

**STANDARD CONSTRUCTION DETAILS  
TRAFFIC**

DATE:  
AUGUST, 2010

REV DATE:  
-

SHEET :  
SD-T02



NOTES:

1. THE GENERAL LAYOUT AND FORMAT OF THE STREET NAME SIGN SHALL BE AS SHOWN IN THE GRAPHIC ABOVE.
2. THE SIGN SHALL BE FABRICATED ON AN ALUMINUM SUBSTRATE, 0.080" THICK, AND SHALL BE 9" IN HEIGHT. THE LENGTH OF THE SIGN SHALL BE PROPORTIONATE TO THE STREET NAME, INCLUDING STREET NAME, SUFFIX, AND BLOCK NUMBER. THE SUBSTRATE SHALL HAVE AN APPROPRIATE RADIUS ON ALL FOUR CORNERS AND SHALL BE OF A FLAT BLADE DESIGN (EXTRUDED SUBSTRATE IS NOT ACCEPTABLE).
3. THE SUBSTRATE SHALL BE SHEETED WITH RETROREFLECTIVE, HIGH INTENSITY PRISMATIC MATERIAL AND SHALL BE WHITE IN COLOR. A PRESSURE SENSITIVE ELECTRO CUT OVERLAY FILM WILL BE USED FOR THE LETTERING AND WILL BE BLUE IN COLOR. THE FONT FOR ALL LETTERING AND NUMBERS SHALL BE BOLD HIGHWAY SERIES 'C.'
4. ALL LETTERING FOR THE STREET NAMES SHALL BE IN CAPITAL LETTERS. THE FIRST LETTER OF THE STREET NAME SHALL BE 5" IN HEIGHT. THE SUBSEQUENT LETTERS OF THE STREET NAME SHALL BE 4" IN HEIGHT. THE LETTERING OF THE SUFFIX SHALL BE ALL CAPITAL LETTERS AND SHALL BE 2.5" IN HEIGHT. THE SUFFIX MAY BE ABBREVIATED. THE SUFFIX SHALL BE PLACED IN THE UPPER RIGHT HAND CORNER OF THE SIGN. THE BLOCK NUMBER SHALL BE PLACED IN THE LOWER RIGHT HAND CORNER OF THE SIGN.



PUBLIC WORKS DEPARTMENT

STREET NAME SIGN SPECIFICATIONS

STANDARD CONSTRUCTION DETAILS TRAFFIC

DATE:  
AUGUST, 2010

REV DATE:  
-

SHEET :  
SD-T03

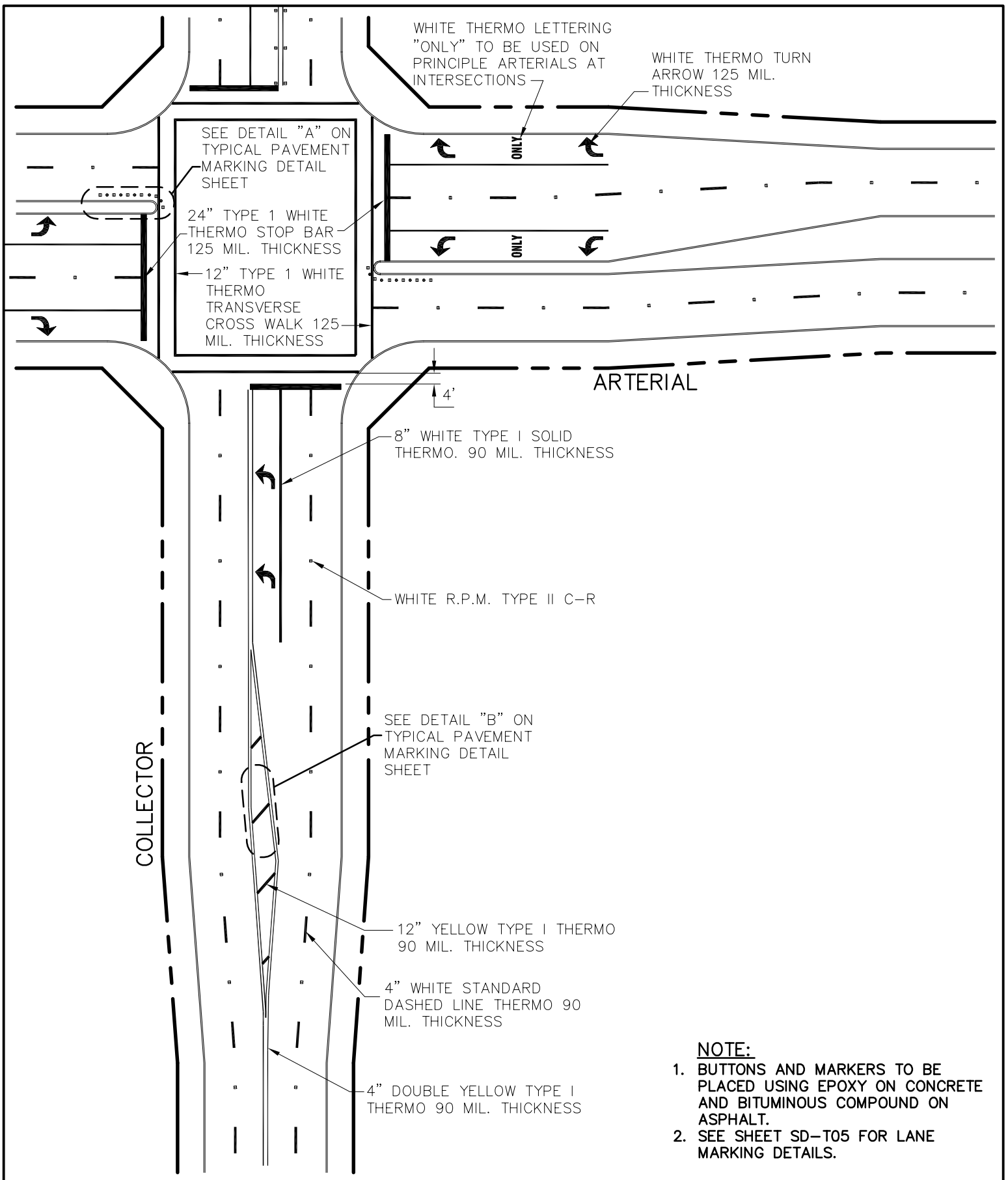

*Addison!*

PUBLIC WORKS DEPARTMENT

TYPICAL PAVMENT MARKING LAYOUT

STANDARD CONSTRUCTION DETAILS TRAFFIC

DATE:  
AUGUST, 2010

REV DATE:  
-

SHEET :  
SD-T04

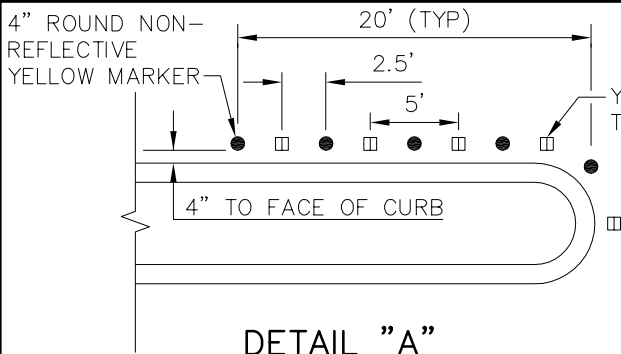

**DETAIL "A"**  
NTS

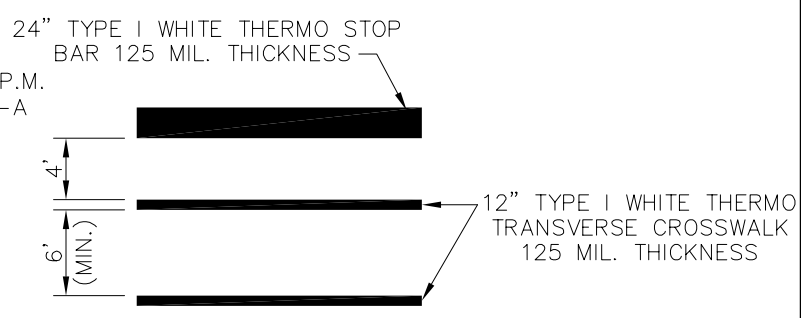

**CROSSWALK STRIPING LAYOUT**  
NTS

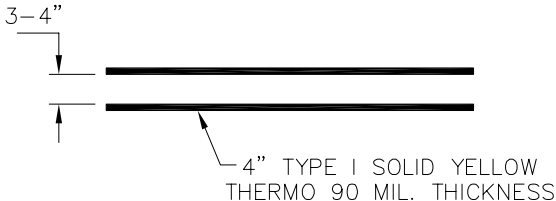

**STANDARD DOUBLE YELLOW LINE**  
NTS

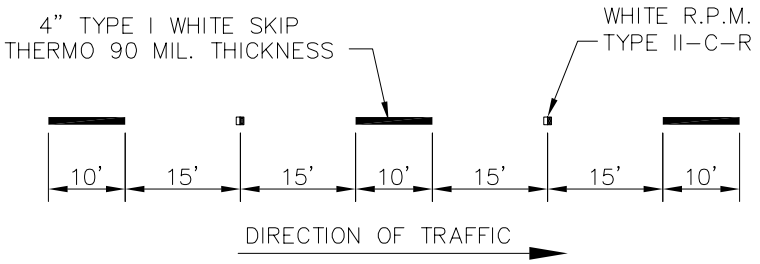

**STANDARD DASHED LINE**  
NTS

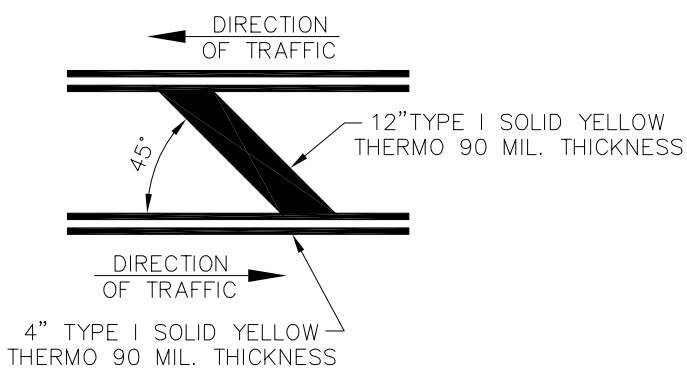

**DETAIL "B"**  
NTS

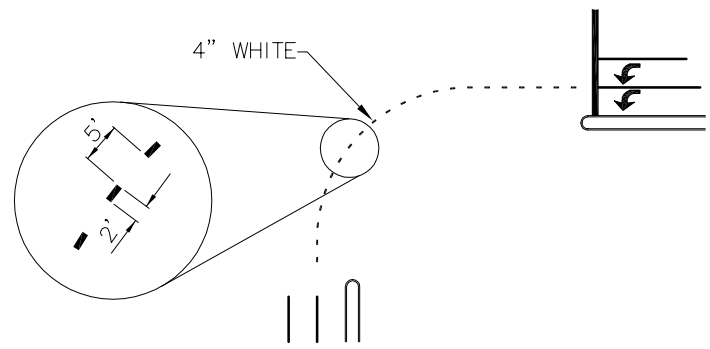

**"PUPPY TRACK" MARKING LAYOUT**  
NTS

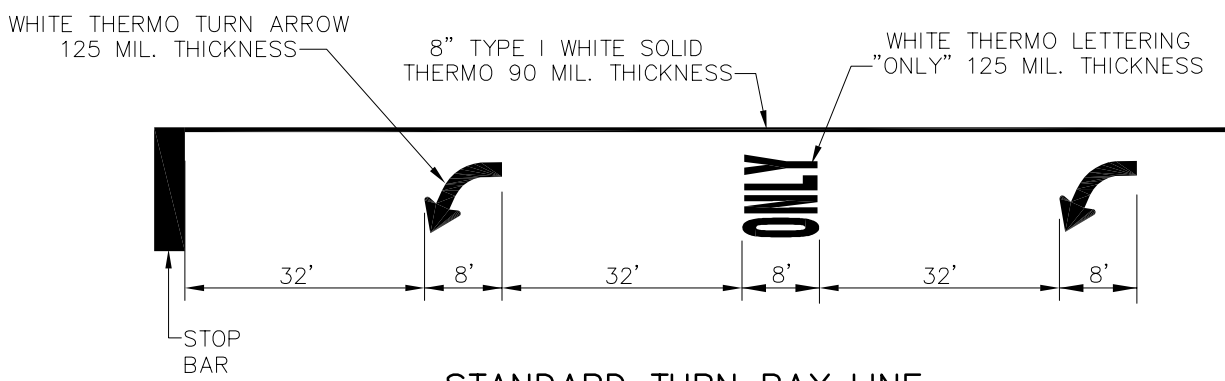

**STANDARD TURN BAY LINE**  
NTS



PUBLIC WORKS DEPARTMENT

TYPICAL PAYMENT MARKING DETAILS

STANDARD CONSTRUCTION DETAILS TRAFFIC

DATE: AUGUST, 2010	REV DATE: -	SHEET : SD-T05
-----------------------	----------------	-------------------

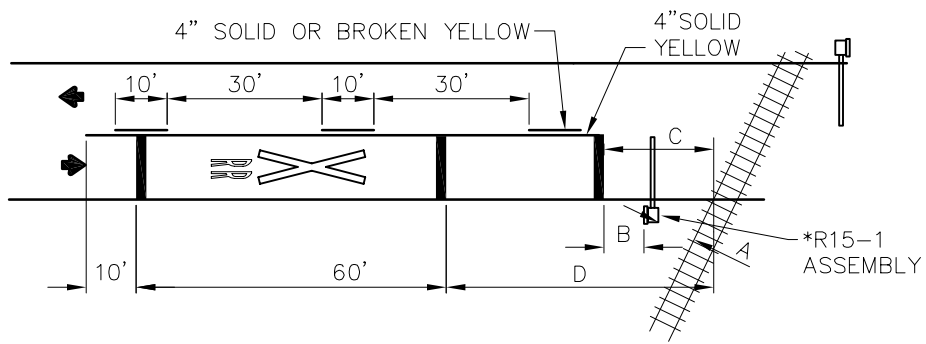

**TWO LANE, TWO-WAY**

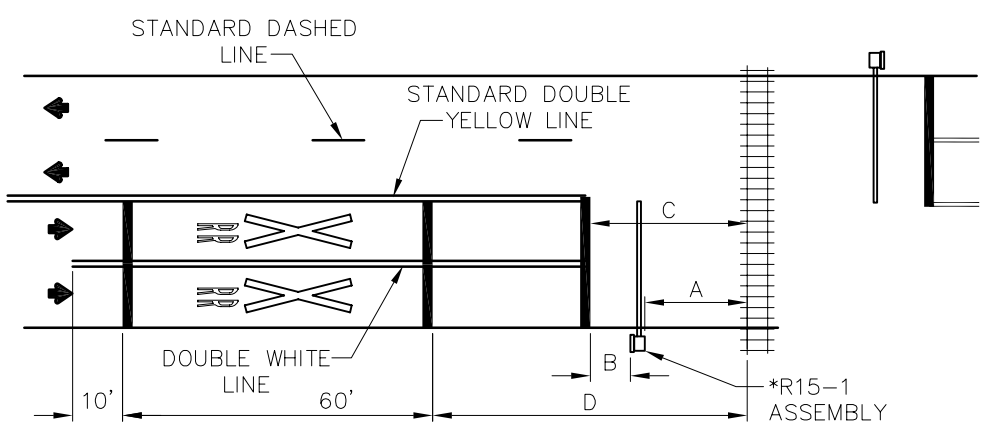

**UNDIVIDED MULTILANE ROADWAY**

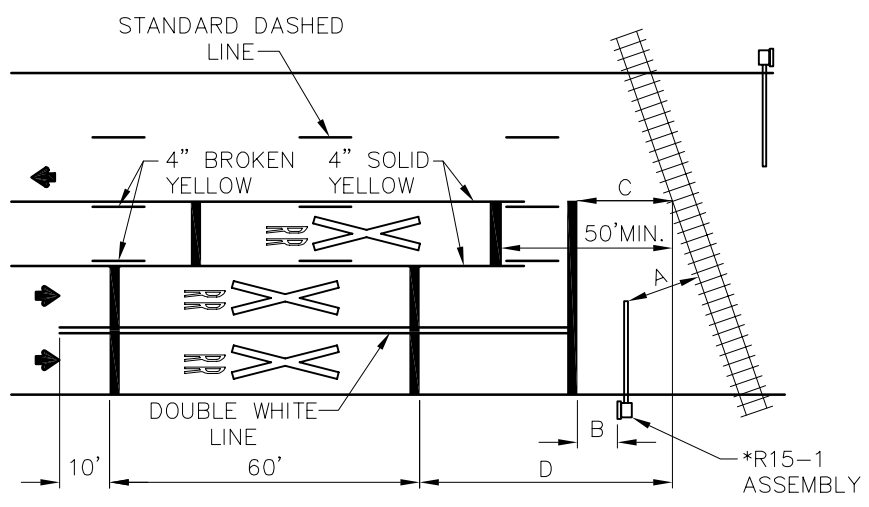

**TWO-WAY LEFT TURN LANE (TWLTL)**

A = 12 FEET MIN., 15 FEET USUAL. IF AUTOMATIC GATES ARE PRESENT DISTANCE "A" SHOULD BE MEASURED FROM NEAREST EDGE OF AUTOMATIC GATES TO RAILS.

B = STOP LINES SHOULD BE PLACED ON 8 FOOT MIN. DISTANCE IN ADVANCE OF R15-1.

C = 15 FEET DESIRABLE MINIMUM. R15-1 SHOULD BE PLACED BETWEEN STOP LINE AND RAILS WITH ADEQUATE DISTANCE PROVIDED FOR "A".

D = APPROACH

SPEED (MPH)	DESIREABLE PACEMENT
	3050'(MIN)
	90' USUAL
	3570'-170'
	40150'-250'
	45235'-335'
	50315'-415'
	55400'-UP (500'USUAL)

\*R15-1 ASSEMBLY MAY CONSIST OF R15-1 AND/OR R15-2, TYPE A, TYPE E OR TYPE F ASSEMBLY.

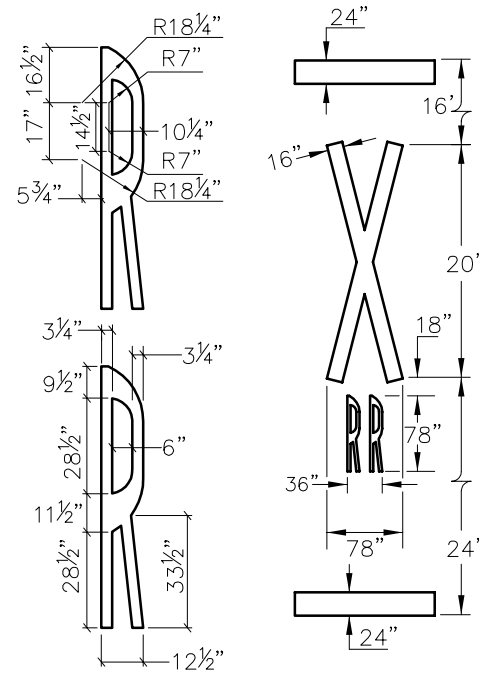

**RAILROAD CROSSING MARKINGS**



PUBLIC WORKS DEPARTMENT

**RAILROAD CROSSING MARKINGS**

**STANDARD CONSTRUCTION DETAILS TRAFFIC**

DATE: AUGUST, 2010	REV DATE: -	SHEET : SD-T06
-----------------------	----------------	-------------------